

## HMEMLL



### Mechanical Series for Sanitary Pumps

- ▶ HMEMLL Seals For E.M.U Pumps, and Mixers.
- ▶ Operational Conditions:  
Temperature:  $-40^{\circ}\text{C}$  to  $+200^{\circ}\text{C}$   
Pressure:  $\leq 1.2\text{MPa}$   
Speed:  $\leq 20\text{m/s}$
- ▶ Materials:  
Stationary Ring:F,Q2  
Rotary Ring:Q2,U2  
Secondary Seal:V,E,P  
Spring and Metal Parts:F,G

规格/Size (公制/Metric)	Code	D1	D2	D3	L
35	0.350	47	72	72	47
50	0.500	63	90	92	52
75	0.750	95	128	130	75

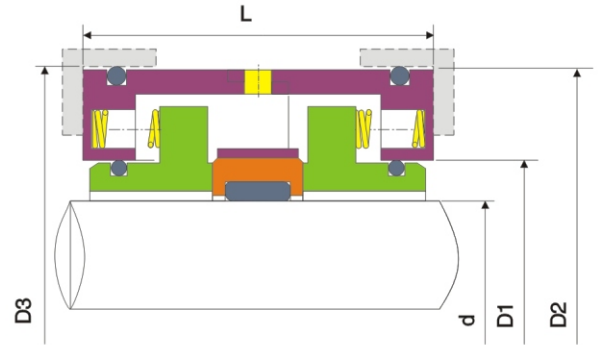

## HMHOM2

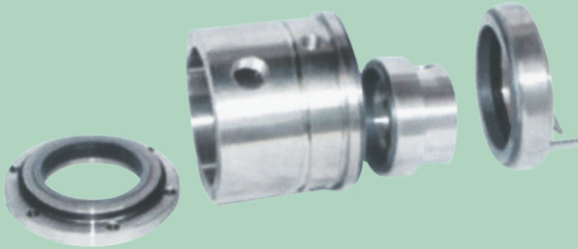

### Mechanical Series for Sanitary Pumps

- ▶ HMHOM2 Seals For Alfa Laval Contherm acraped surface heat exchangers.
- ▶ Materials:  
Stationary Ring:Q2  
Rotary Ring:B  
Secondary Seal:V,P,E  
Spring and Marts:F,G

